

# Booth Construction and Layout

## LINEAR BOOTHS

### Dimensions

For purposes of consistency and ease of layout and/or reconfiguration, floor plan design in increments of 10' (3.05m) has become the de facto standard in the United States. Therefore, unless constricted by space or other limitations, linear booths are most commonly 10' (3.05m) wide and 10' (3.05m) deep. A maximum back wall height limitation of 8' (2.44m) is generally specified.

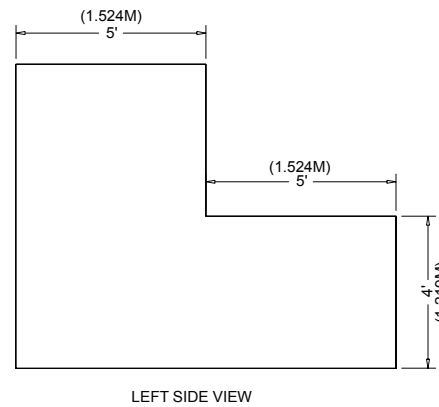
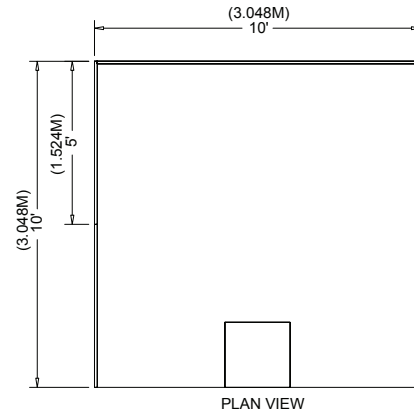

### USE OF SPACE

Regardless of the number of linear booths utilized, e.g. 10' by 20' (3.05m by 6.10m), 10' by 30' (3.05m by 9.14m), 10' by 40' (3.05m by 12.19m), etc. display materials should be arranged in such a manner so as not to obstruct sight lines of neighboring exhibitors. The maximum height of 8' (2.44m) is allowed only in the rear half of the booth space, with a 4' (1.22m) height restriction imposed on all materials in the remaining space forward to the aisle. (See Regulation 20 on page 2 of Exhibition Regulations.)

**Note:** When three or more linear booths are used in combination as a single exhibit space, the 4' (1.22m) height limitation is applied only to that portion of exhibit space which is within 10' (3.05m) of an adjoining booth.

## CORNER BOOTHS

A corner booth is a linear booth exposed to aisles on two sides. All other guidelines for linear booths apply.

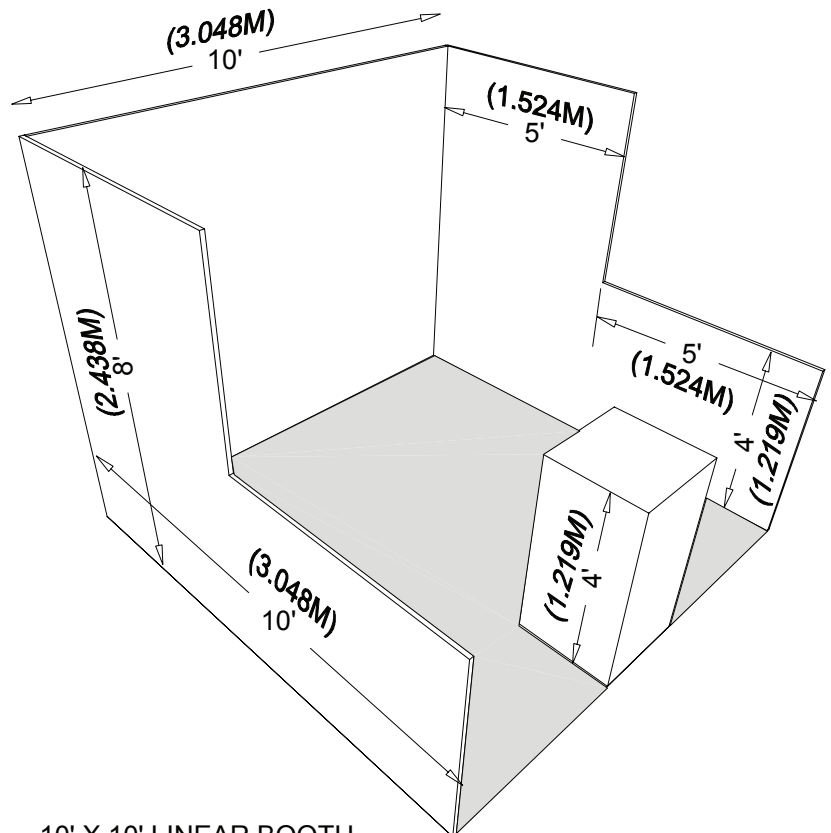
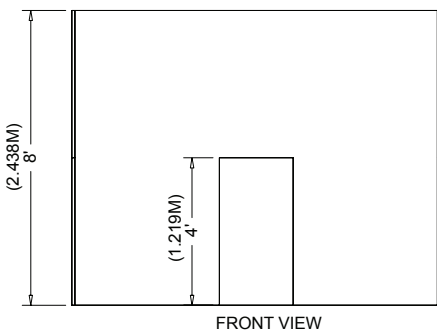

10' X 10' LINEAR BOOTH

## Booth Construction and Layout (continued)

### ISLAND BOOTHS

An island booth is any size booth exposed to aisles on all four sides.

#### Dimensions

An island booth is typically 20' x 20' or larger, although it may be configured differently.

#### Use of Space

The entire cubic content of the space may be used up to the maximum allowable height, which is 18', including signage. (See Regulation 20 on page 2 of Exhibition Regulations.)

Send island booth design and height measurements to [vwolf@aaoms.org](mailto:vwolf@aaoms.org) 60 days prior to meeting for review and approval.

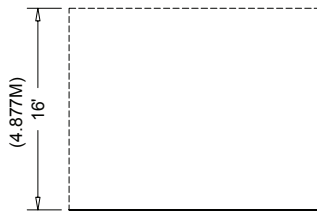
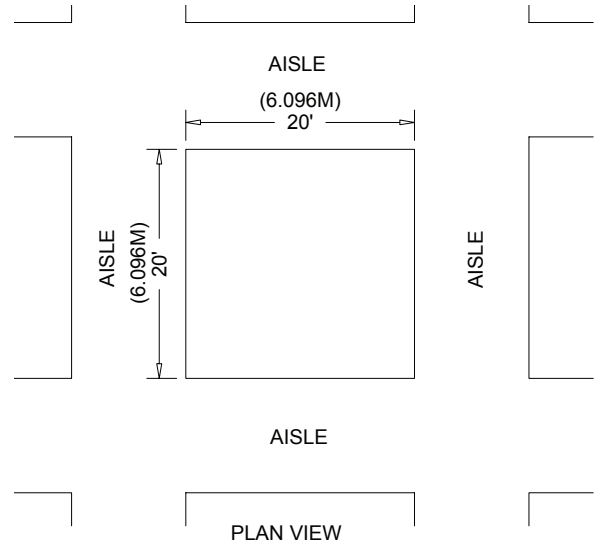

FRONT VIEW

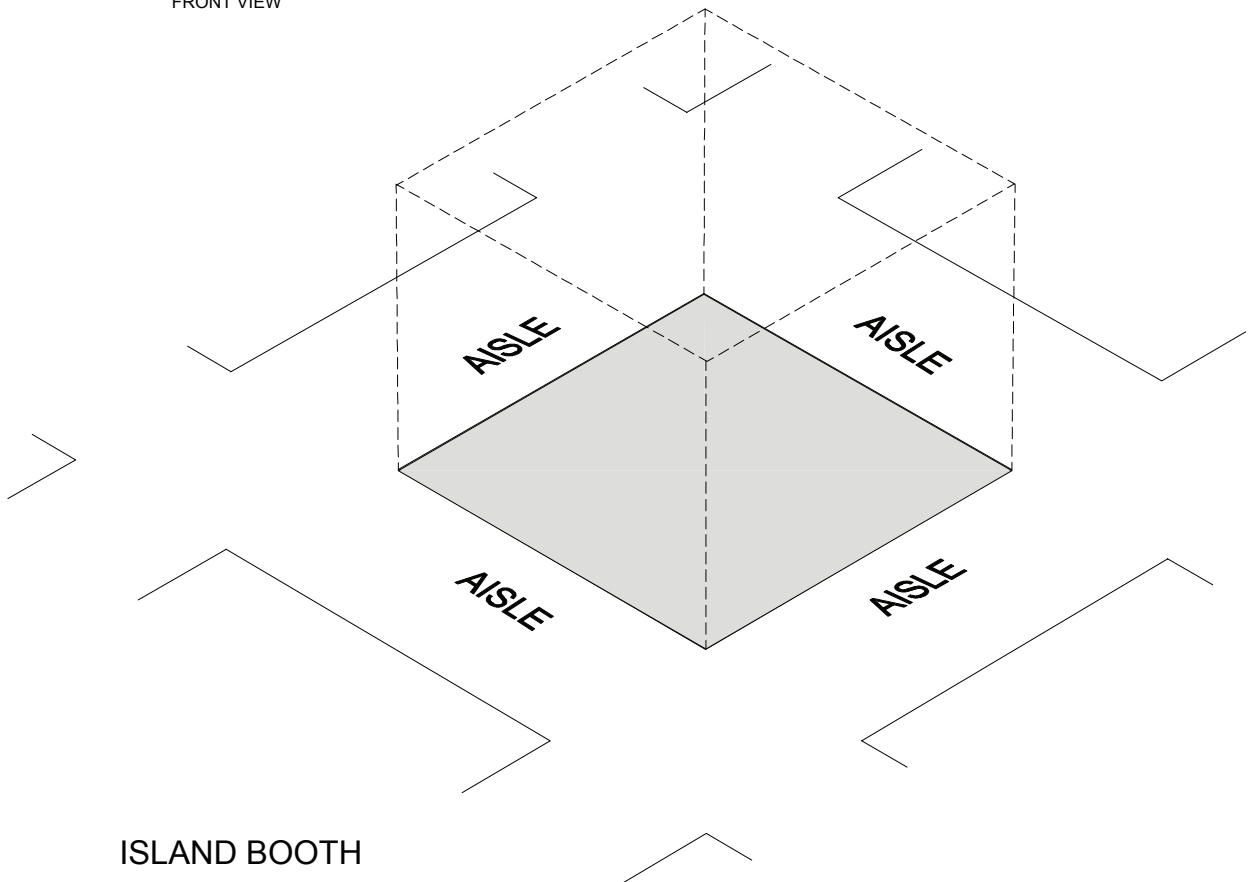

ISLAND BOOTH

# Booth Construction and Layout (continued)

## PENINSULA BOOTHS

A peninsula booth is exposed to aisles on three (3) sides and composed of a minimum of four booths. There are two types of peninsula booths: (a) one which backs up to linear booths, and (b) one which backs to another peninsula booth and is referred to as a “split island booth.”

### Dimensions

A peninsula booth is usually 20' x 20' or larger. When a peninsula booth backs up to two linear booths, the backwall is restricted to four feet (4') high within five feet (5') of each aisle, permitting adequate line of sight for the adjoining linear booths. 18 feet (18') is a typical maximum height allowance, including signage for the center portion of the backwall. (See Regulation 20 on page 2 of Exhibition Regulations.)

Send peninsula booth design and height measurements to [vwolf@aaoms.org](mailto:vwolf@aaoms.org) 60 days prior to meeting for review and approval.

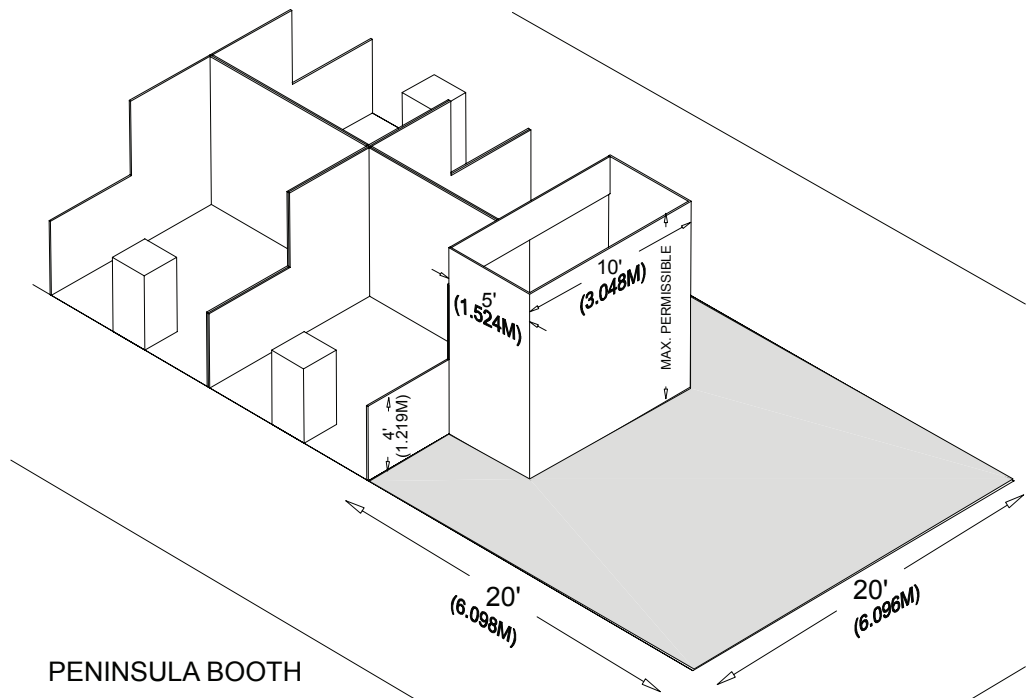
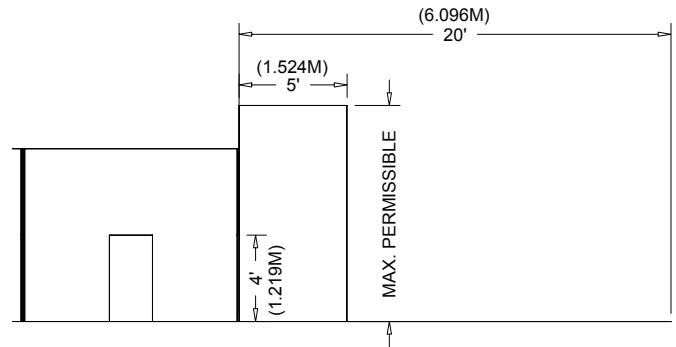
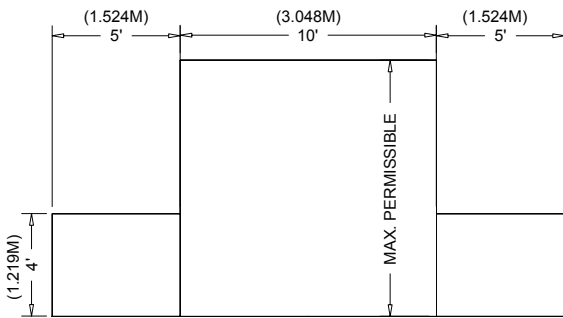
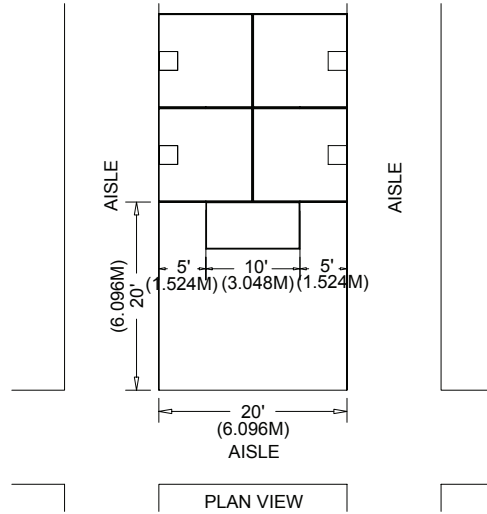

## Booth Construction and Layout (continued)

### END-CAP BOOTHS

An end-cap booth is exposed to aisles on three sides and composed of two booths.

#### Dimensions

End-cap booths are generally ten feet (10') deep by 20 feet (20') wide. The maximum backwall height of eight feet (8') is allowed only in the rear half of the booth space and within five feet (5') of the two side aisles with a four foot (4') height restriction imposed on all materials in the remaining space forward to the aisle (See regulation 20 on page 2 of the Exhibition Regulations). Send end-cap booth designs and measurements to [vwolf@aaoms.org](mailto:vwolf@aaoms.org) 60 days prior to the meeting for review and approval.

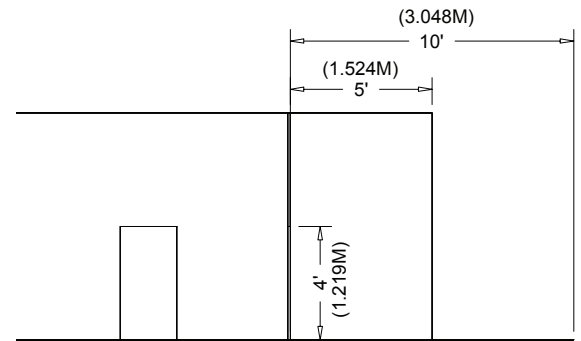

LEFT SIDE VIEW

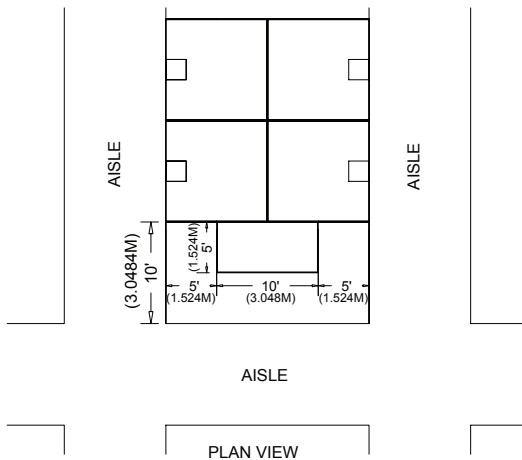

PLAN VIEW

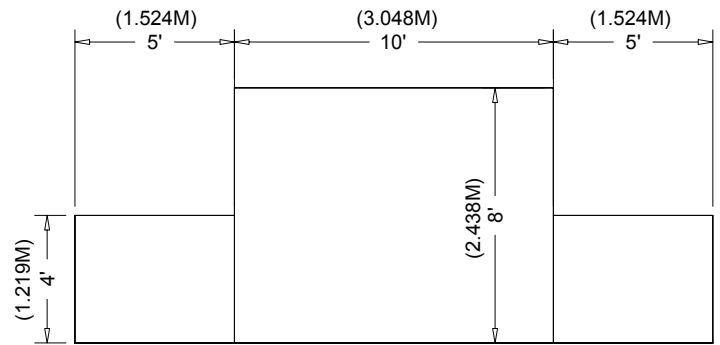

FRONT VIEW

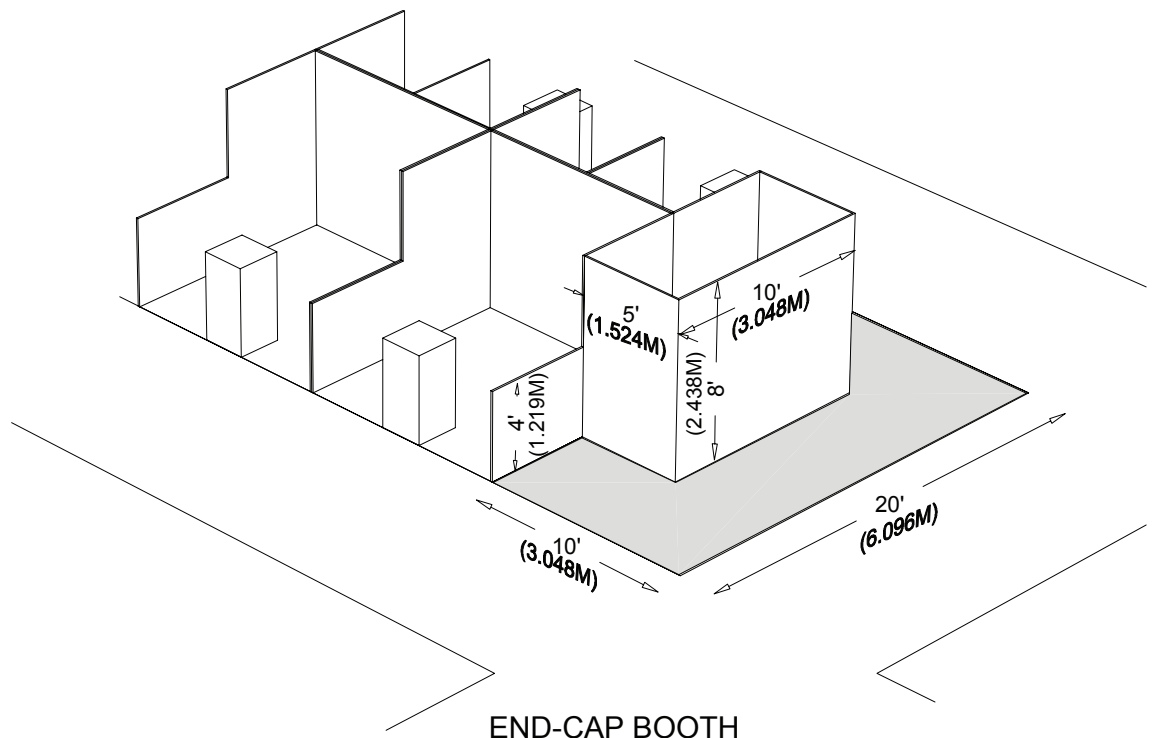

END-CAP BOOTH

## Booth Construction and Layout (continued)

### 10+ BOOTH LINEAR

\$100 per 10 x 10 discount at 10 or more continuous booths

Perimeter booth selection allows a 12' height limitation

Non-perimeter linear booth selection = 8' height limitation

\*See Exhibitor Application and Contract for details.

### LINEAR BOOTHS

#### Dimensions

For purposes of consistency and ease of layout and/or reconfiguration, floor plan design in increments of 10' (3.05m) has become the de facto standard in the United States. Therefore, unless constricted by space or other limitations, linear booths are most commonly 10' (3.05m) wide and 10' (3.05m) deep, i.e. 10' by 10' (3.05m by 3.05m). A maximum back wall height limitation of 8' (2.44m) is generally specified.

#### USE OF SPACE

Regardless of the number of linear booths utilized, e.g. 10' by 20' (3.05m by 6.10m), 10'x100' (3.05m by 9.14m), 10'x40' (3.05m by 12.19m), etc. display materials should be arranged in such a manner so as not to obstruct sight lines of neighboring exhibitors. The maximum height of 8' (2.44m) is allowed only in the rear half of the booth space, with a 4' (1.22m) height restriction imposed on all materials in the remaining space forward to the aisle. (See Regulation 20 on page 2 of Exhibition Regulations.)

**Note:** When three or more linear booths are used in combination as a single exhibit space, the 4' (1.22m) height limitation is applied only to that portion of exhibit space which is within 10' (3.05m) of an adjoining booth.

### CORNER BOOTHS

A corner booth is a linear booth exposed to aisles on two sides.

All other guidelines for linear booths apply.

